

# Weatherization Works!



207-645-3764

[www.wmca.org](http://www.wmca.org)

1-800-645-9636

**Western Maine Community Action Energy savings shown by a random selection of  
13 Fully Weatherized Housing Units in Franklin County (Fuel at \$3.70/gallon- current price 02/2012)**

Town	Dwelling type	Pre-wx fuel (gallons)	Post-wx fuel (gallons)	Fuel saved (gallons)	Percent of Fuel Reduction	Annual dollars saved @ \$3.70/gal	Client Cost of Wx	Payback period (years)
Phillips	Mobile Home	725	444	<b>281</b>	<b>38.8%</b>	\$1,040	5,756	5.5
Strong	Mobile Home	700	328	<b>372</b>	<b>53.1%</b>	\$1,376	6,093	4.4
Strong	Mobile Home	500	214	<b>286</b>	<b>57.2%</b>	\$1,058	5,110	4.8
Farmington	Mobile Home	550	300	<b>250</b>	<b>45.5%</b>	\$925	4,518	4.9
Farmington	Single Family	1,100	583	<b>517</b>	<b>47.0%</b>	\$1,913	8,106	4.2
Wilton	Single Family	700	362	<b>338</b>	<b>48.3%</b>	\$1,251	4,523	3.6
Strong	Single Family	1,341	903	<b>438</b>	<b>32.7%</b>	\$1,621	11,146	6.9
Jay	Single Family	825	400	<b>425</b>	<b>51.5%</b>	\$1,573	4,822	3.1
Freeman Twp.	Single Family	828	445	<b>383</b>	<b>46.3%</b>	\$1,417	5,988	4.2
Chesterville	Single Family	550	402	<b>148</b>	<b>26.9%</b>	\$548	4,982	9.1
New Sharon	Single Family	545	140	<b>405</b>	<b>74.3%</b>	\$1,499	9,347	6.2
Wilton	Single Family	600	175	<b>425</b>	<b>70.8%</b>	\$1,573	7,612	4.8
Strong	Single Family	900	541	<b>359</b>	<b>39.9%</b>	\$1,328	5,454	4.1
	<b>TOTALS</b>	<b>11,014</b>	<b>6,100</b>	<b>4,914</b>		<b>\$18,182</b>	<b>\$98,184</b>	
	<b>* AVERAGES</b>	<b>734</b>	<b>407</b>	<b>328</b>	<b>45.5%</b>	<b>\$1,212</b>	<b>\$6,546</b>	<b>6.2</b>

**\* For every three units weatherized approximately 1,000 gallons of fuel will be saved every year. WMCA produced over 250 units that were weatherized under DOE ARRA Funds, equating to more than 80,000 gallons a year and over \$300 thousand dollars currently being saved in Franklin County, Maine every year going forward.**

Ice dams are a common problem caused by heat loss through the roof of a home





# Attic Solutions





# Wall & Knee Wall Solutions

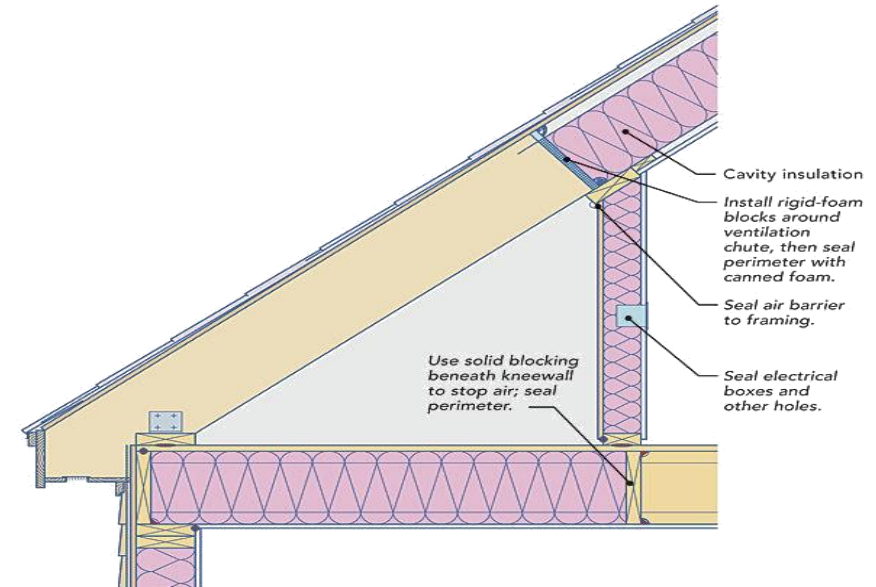
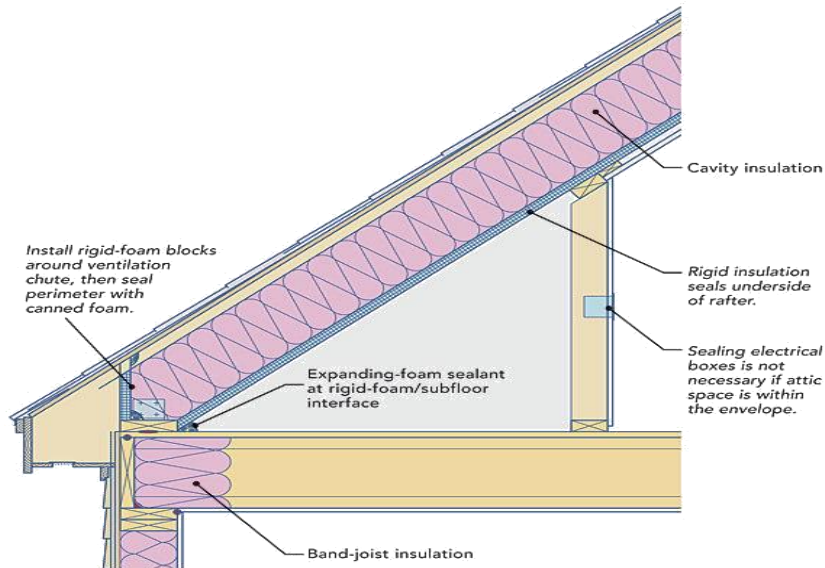

# Basement Solutions







# Home Repair Services



## Before, during and after...

**We take on a wide variety of projects that will enable the low income, elderly, and veterans to remain in their homes.**

**From repairs to the addition of accessibility measures, WMCA approaches each project with the goal of ensuring the health, safety and comfort of each client through the most efficient means available.**







**Before, During, and  
After**















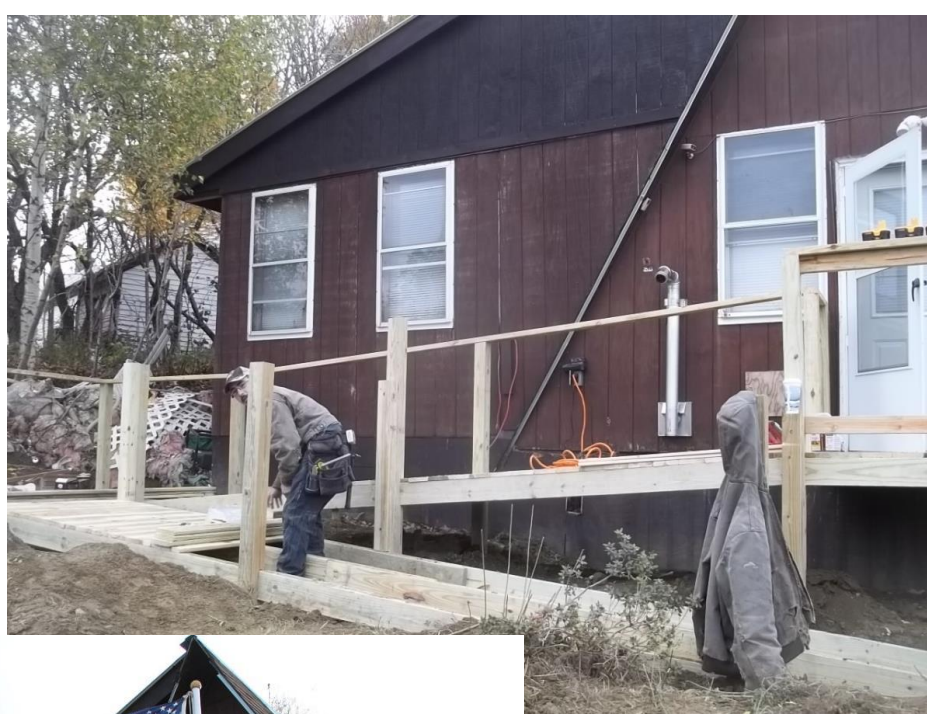





**Site Improvements for Home Repair may include wells and septic system repairs / replacements.**





# COMMUNITY HOME REPLACEMENT PROJECT

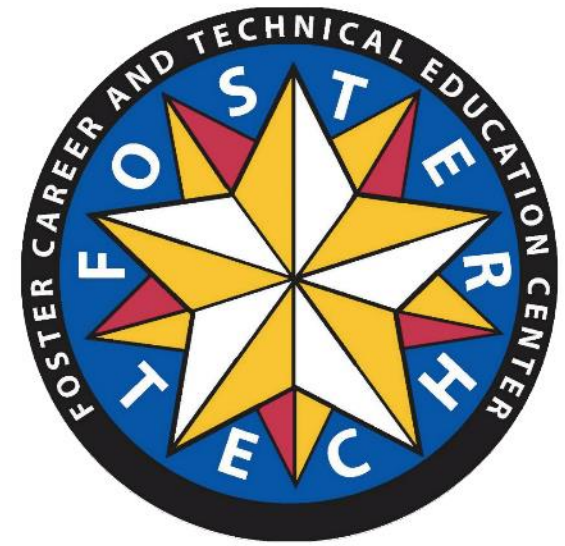

Department of Economic  
& Community Development



**Hammond**  
**Lumber Company**



Skowhegan  
Savings

**CHRETIEN'S CONSTRUCTION**  
GENERAL CONTRACTOR

**JOHN T. GORMAN**  
FOUNDATION



**MOTTRAM**  
ARCHITECTURE

**Maine**  
Community Foundation



Rural Development





# Community Home Replacement Project



It took 10 cords of wood and 250 gallons of oil to heat the old mobile home – estimated at \$3,000 each year



Equipped with a Heat Recovery Ventilator and Heat Pump, new estimates are only \$320 annually – a savings of 89%





Peter Thayer, WMCA  
Home Repair Technician, deserves  
high praise for his dedication and  
the handling of this complicated  
and highly logistical project.

